

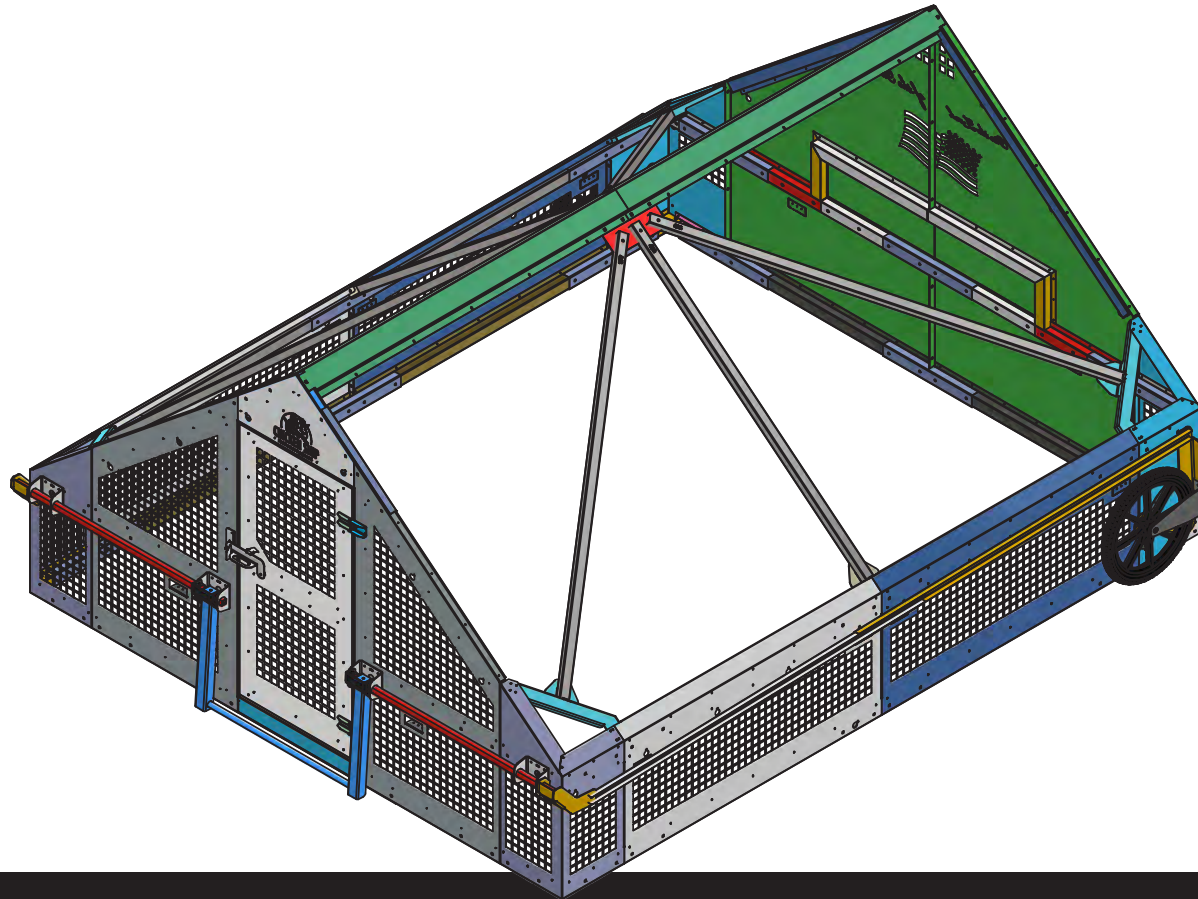

# CHICKEN SHIP ASSEMBLY INSTRUCTION MANUAL



**CAUTION:** Wear gloves and protective eyewear.



**CAUTION:** Self-drilling screws produce small aluminum scraps that are dangerous to chickens. Dispose of all aluminum scraps properly.

# TABLE OF CONTENTS

<b>Parts List .....</b>	<b>2</b>
<b>Assembly Instructions.....</b>	<b>9</b>
Step 1: Corner Assembly .....	9
Step 2: Side Panel Assembly .....	10
Step 3: Corner Installation .....	11
Step 4: Back Assembly .....	12
Step 5: Front Assembly.....	13
Step 6: Final Front Assembly.....	14
Step 7: Coop Assembly.....	15
Step 8: Panel Flange Assembly.....	16
Step 9: Sidewall Panel Assembly.....	17
Step 10: Middle Roof Support Installation .....	18
Step 11: Ridge Assembly .....	19
Step 12: Ridge Cap Installation .....	20
Step 13: Roof Brace Installation .....	21
Step 14: Door and Latch Installation.....	22
Step 15: Wheel Assembly .....	23
Step 16: Wheel Installation .....	24
Step 17: Handle Installation.....	25
Step 18: Wheel Pull Channels.....	27

# SAFETY FIRST, STEWARDSHIP ALWAYS.

At Featherman, we believe that every piece of equipment we build—like the Chicken Ship—is part of a bigger story. It's about caring for your birds and your land, balancing flexibility and stewardship, and working in harmony with the seasons and your goals.

Whether you're raising broilers, layers, or a mix of both, the Chicken Ship was designed with adaptability in mind—rooted in the lessons of the land and built to stand the test of time.

For video setup guidance, scan the QR code  
on this page or visit our website:  
**[www.feathermanequipment.com/how-to-videos](http://www.feathermanequipment.com/how-to-videos)**



Use the Chicken Ship responsibly, following all instructions carefully and inspecting it regularly. Any modification outside our recommended guidelines can present safety risks and void the warranty.

Featherman cannot be held responsible for any injuries or damage resulting from improper use or failure to follow these instructions.

# PARTS LIST

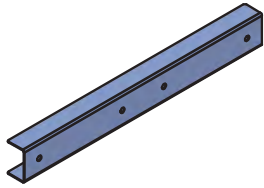

24x Main Splice Connector

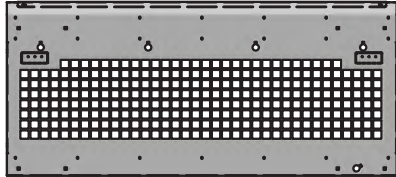

2x Side Panel Front (1 Left, 1 Right)

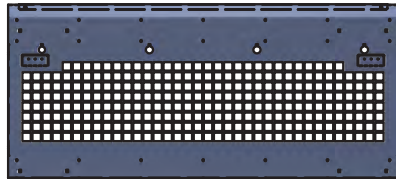

2x Side Panel Back



1x Logo Plate

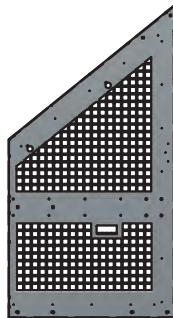

1x Front Left Panel

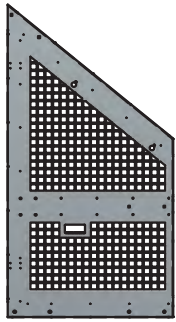

1x Front Right Panel



1x Door Threshold

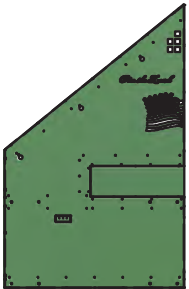

1x Back Left Panel

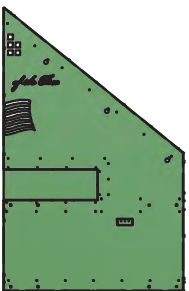

1x Back Right Panel

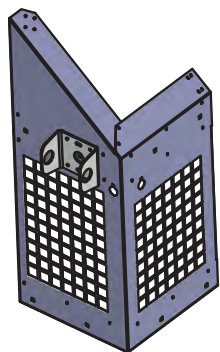

2x Front Corner  
(1 Left, 1 Right)

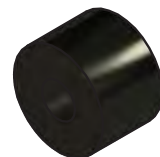

1x Door Latch Bushing

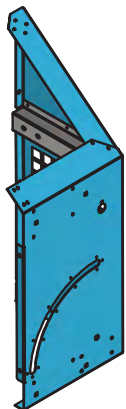

2x Back Corner  
(1 Left, 1 Right)



1x Door Latch

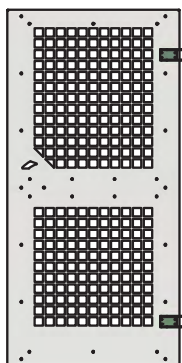

1x Door Assembly



1x Handle Assembly

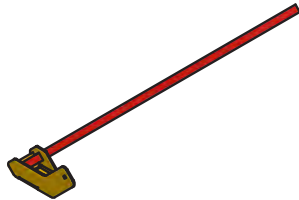

2x Shaft Assembly (1 Left, 1 Right)

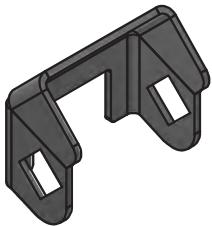

2x Handle Stop Bracket



2x Side Pull 1



2x Side Pull 2



2x Wheels



2x Wheel Cam (1 Left, 1 Right)



2x Wheel Mount Bracket



2x Wheel Step Bushing (plastic)



4x Stainless Washer



2x Wheel Guide Bushing (plastic)



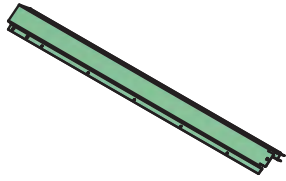

2x Ridge Cap

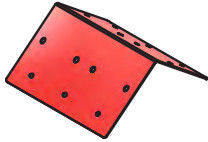

1x Ridge Connector

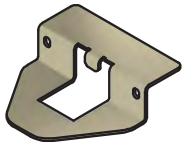

2x Sidewall Roof Support Connector

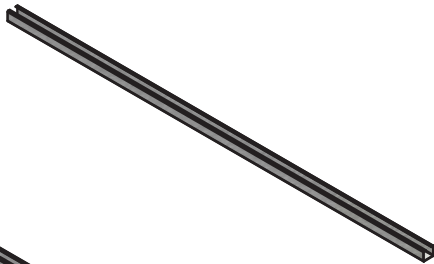

2x Middle Roof Brace



4x Corner Roof Brace

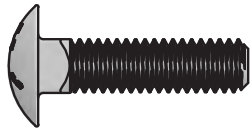

102x 5/16" x 2.5" Carriage Bolt

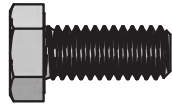

54x 5/16" x 1" Hex Bolt



8x 5/16" x 1" Carriage Bolt



4x 1/2" x 2" Hex Bolt

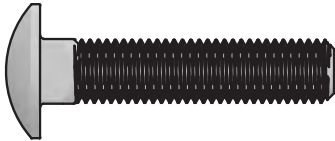

2x 3/4" x 3.5" Carriage Bolt



3x 1/4" x 2.5 Hex Bolt



2x 1/4" x 2" Hex Bolt



151x 5/16" Flange Nuts



2X 3/4" Lock Nut



4x 1/2" Lock Nut



8x 5/16" Lock Nut



5x 1/4" Lock Nut

# ASSEMBLY INSTRUCTIONS

## Step 1: Corner Assembly

Install 4x main splice connectors to inside of each corner assembly.

NOTE: Do not fully tighten connectors until final assembly.

Use 32x 5/16" x 2.5" carriage bolts and 32x flange nuts.

### Assembly Tip

Do not fully tighten bolts or hardware during initial assembly. This allows for better alignment across all panels. Final tightening should be done only after full assembly is complete. There is no need to re-tighten or revisit bolts once everything is secure.

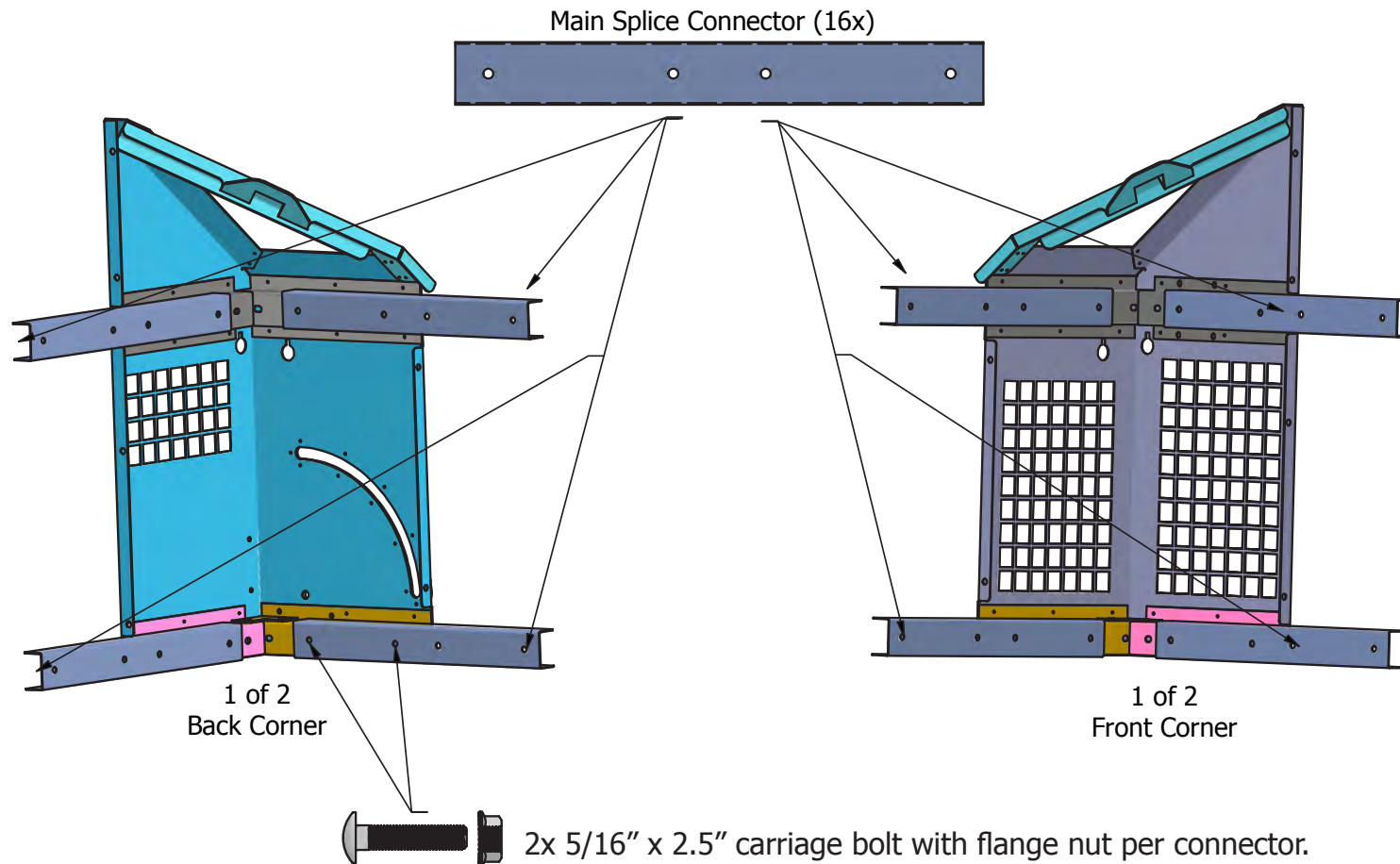

## Step 2: Side Panel Assembly

Assemble side panels with main splice connectors (2 per side).  
Assemble second side panel section mirrored from the first.

Use 8x 5/16" x 2.5"  
carriage bolts with  
flange nuts per side.



2x per side

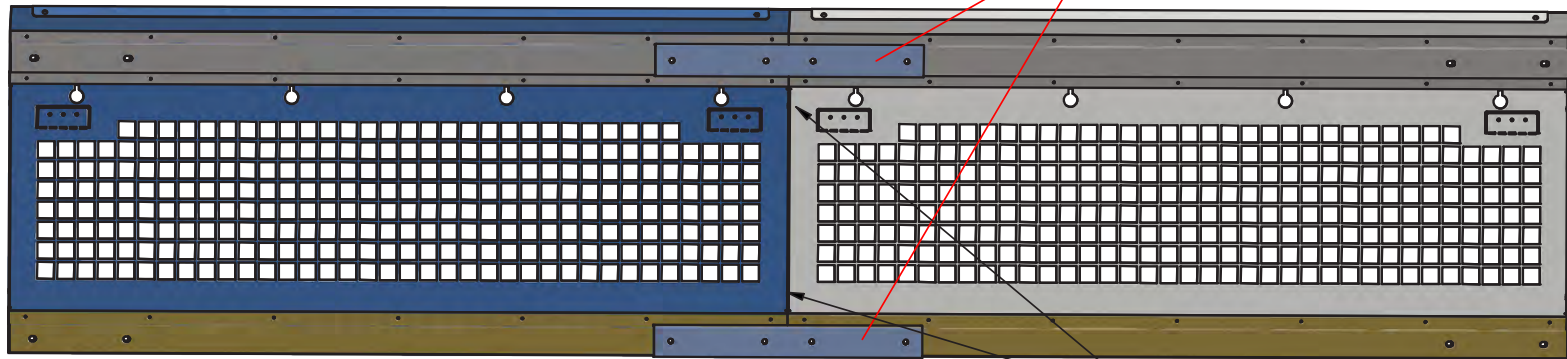

Install side panels with tarp  
hole connectors as shown.



Use 2x 5/16" x 1"  
hex bolts with flange  
nuts per side.

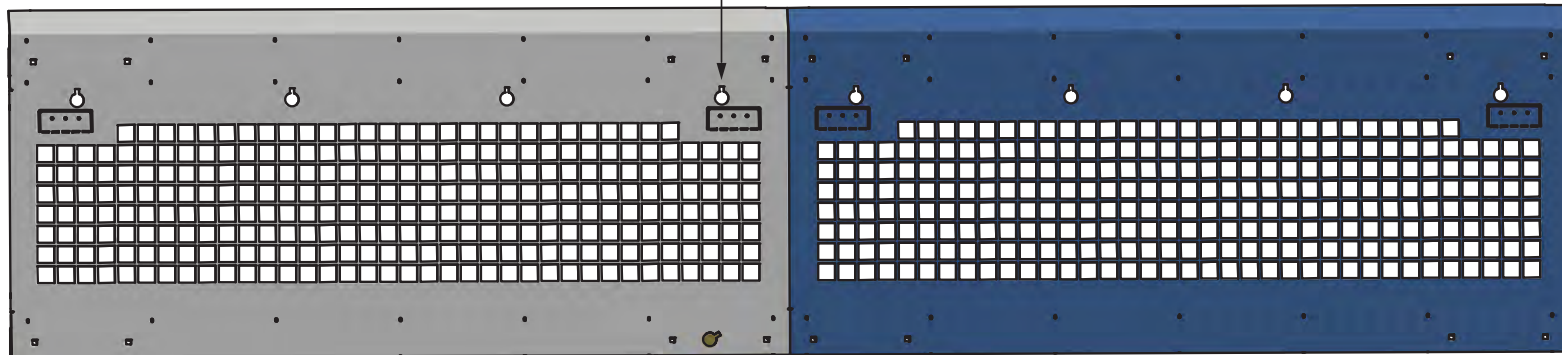

Front

Back

### Step 3: Corner Installation

Install corners onto side assemblies.

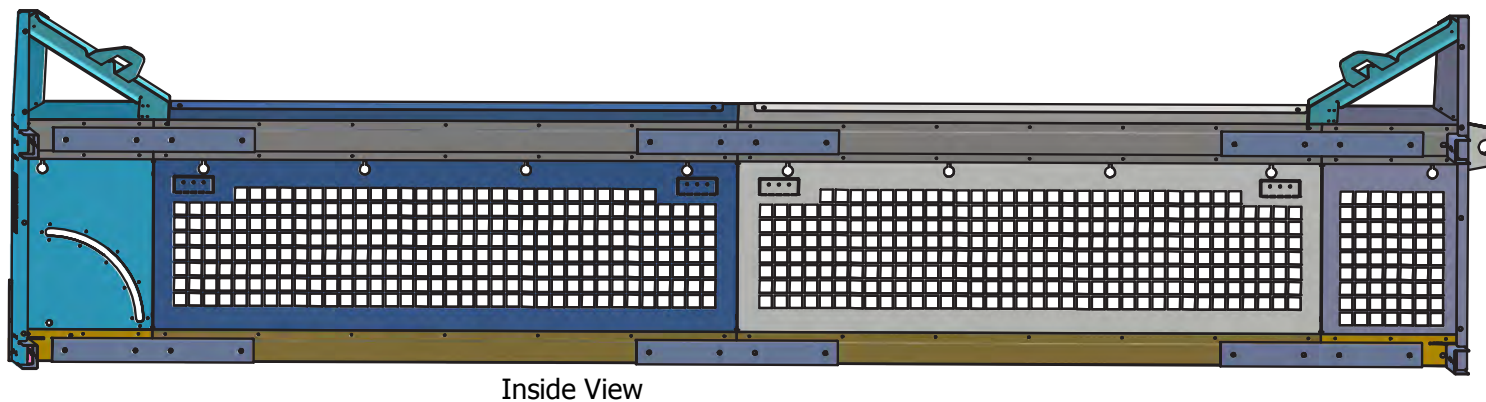
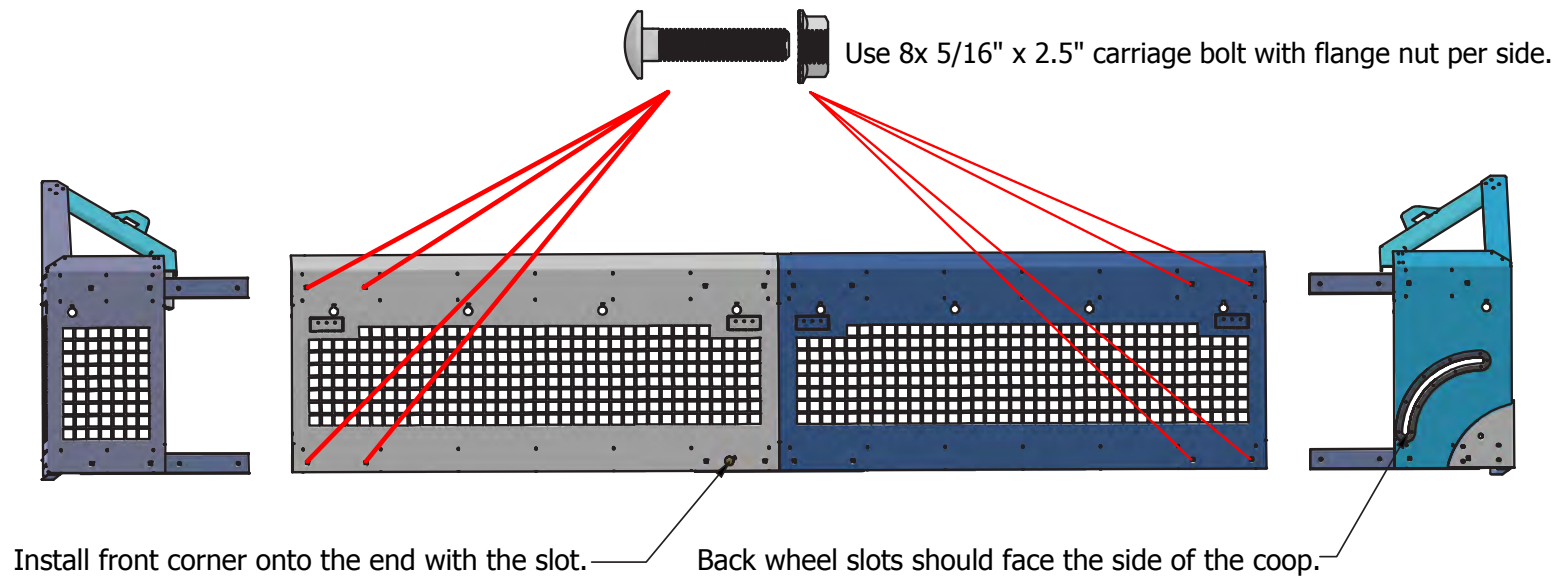

## Step 4: Back Assembly

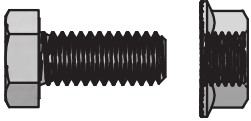

Use 5x 5/16" x 1" hex bolts with flange nuts along the center flange.

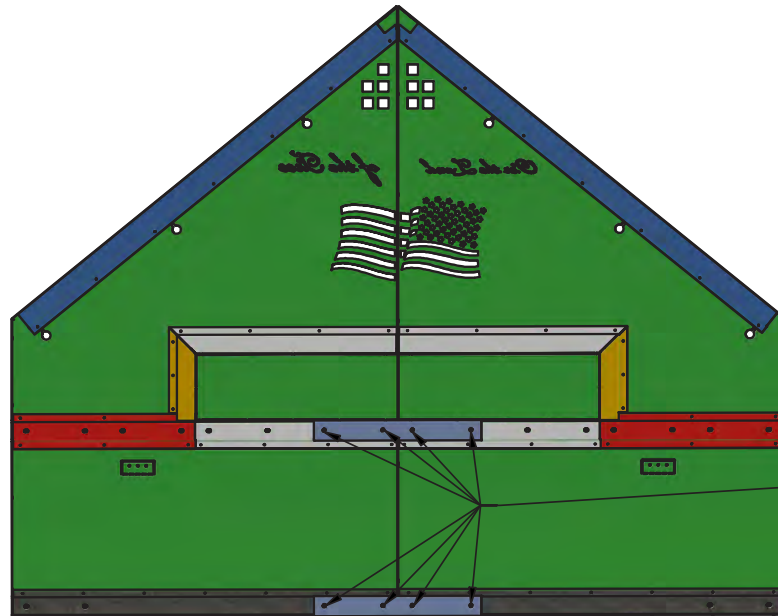
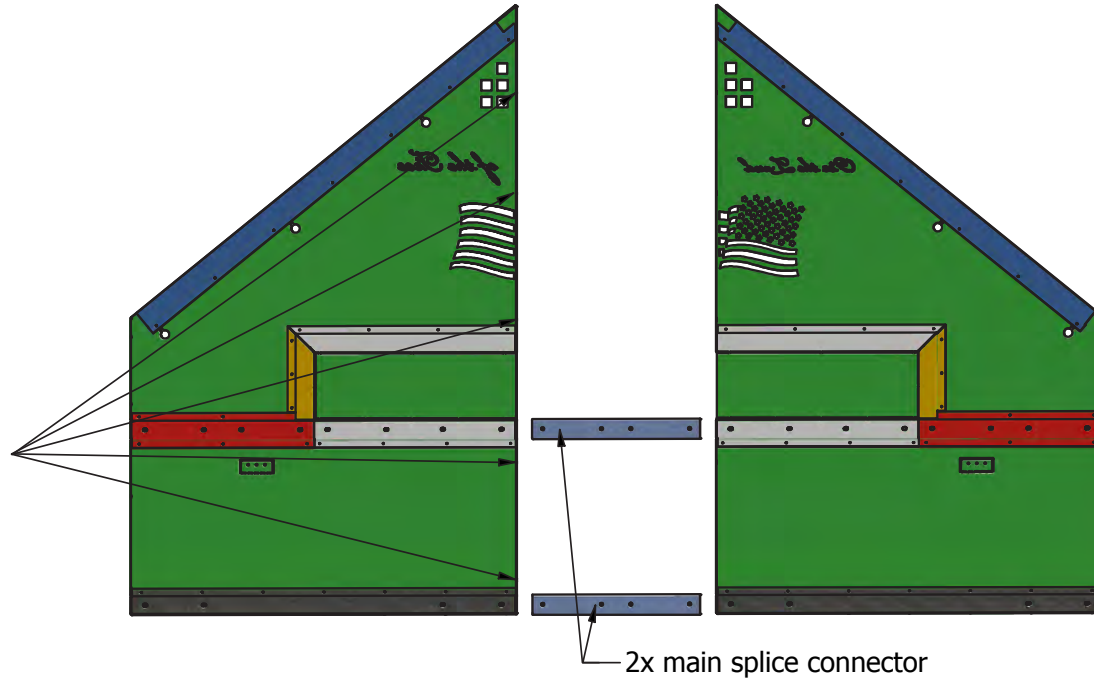

Use 8x 5/16" x 2.5" carriage bolts with flange nuts.

## Step 5: Front Assembly

Attach main splice connectors to logo plate.

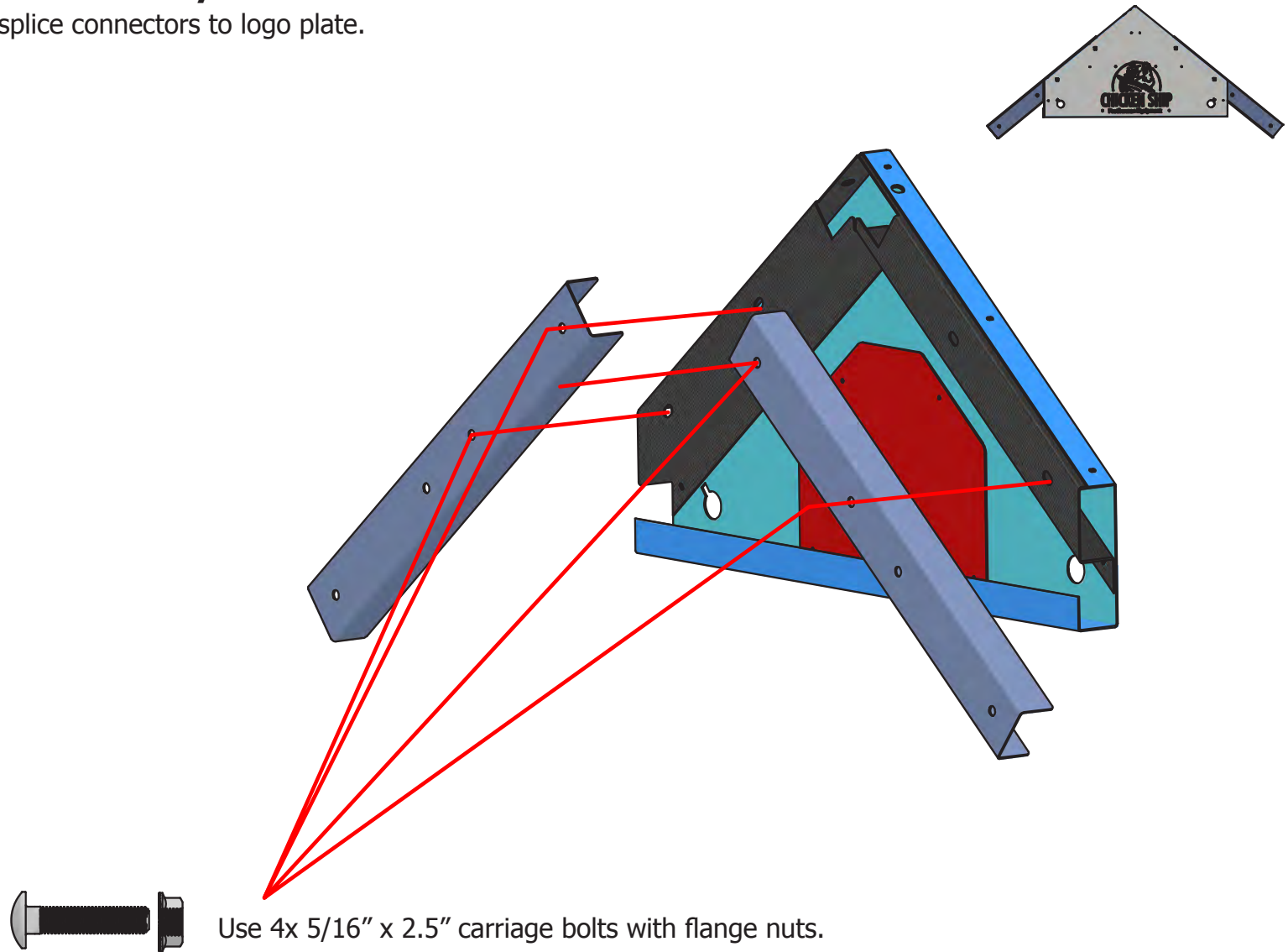



## Step 6: Final Front Assembly

Attach main splice connectors to the logo plate to inside of coop panels.

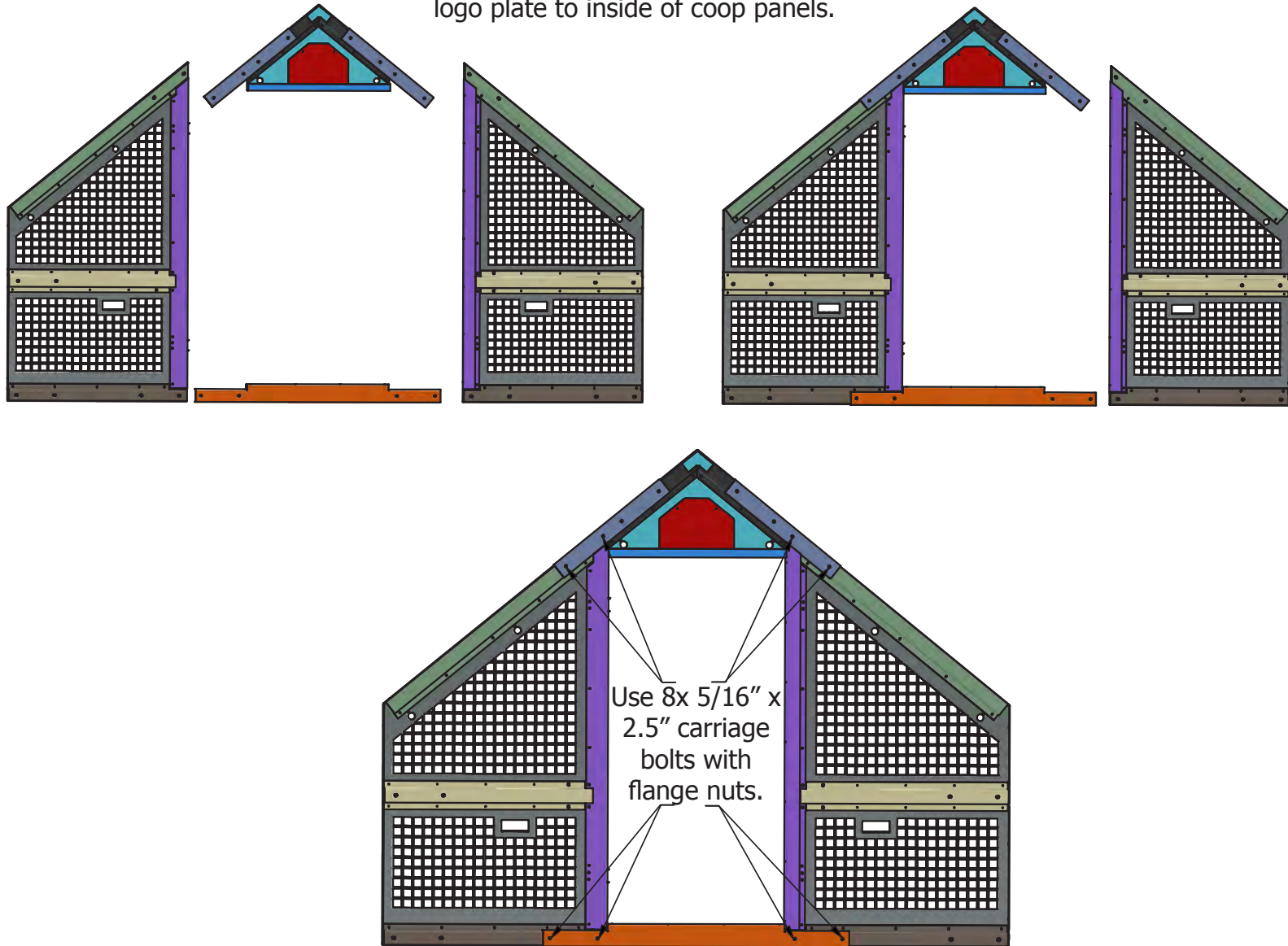



## Step 7: Coop Assembly

Use 16x 5/16" X 2.5" carriage bolts with flange nuts.

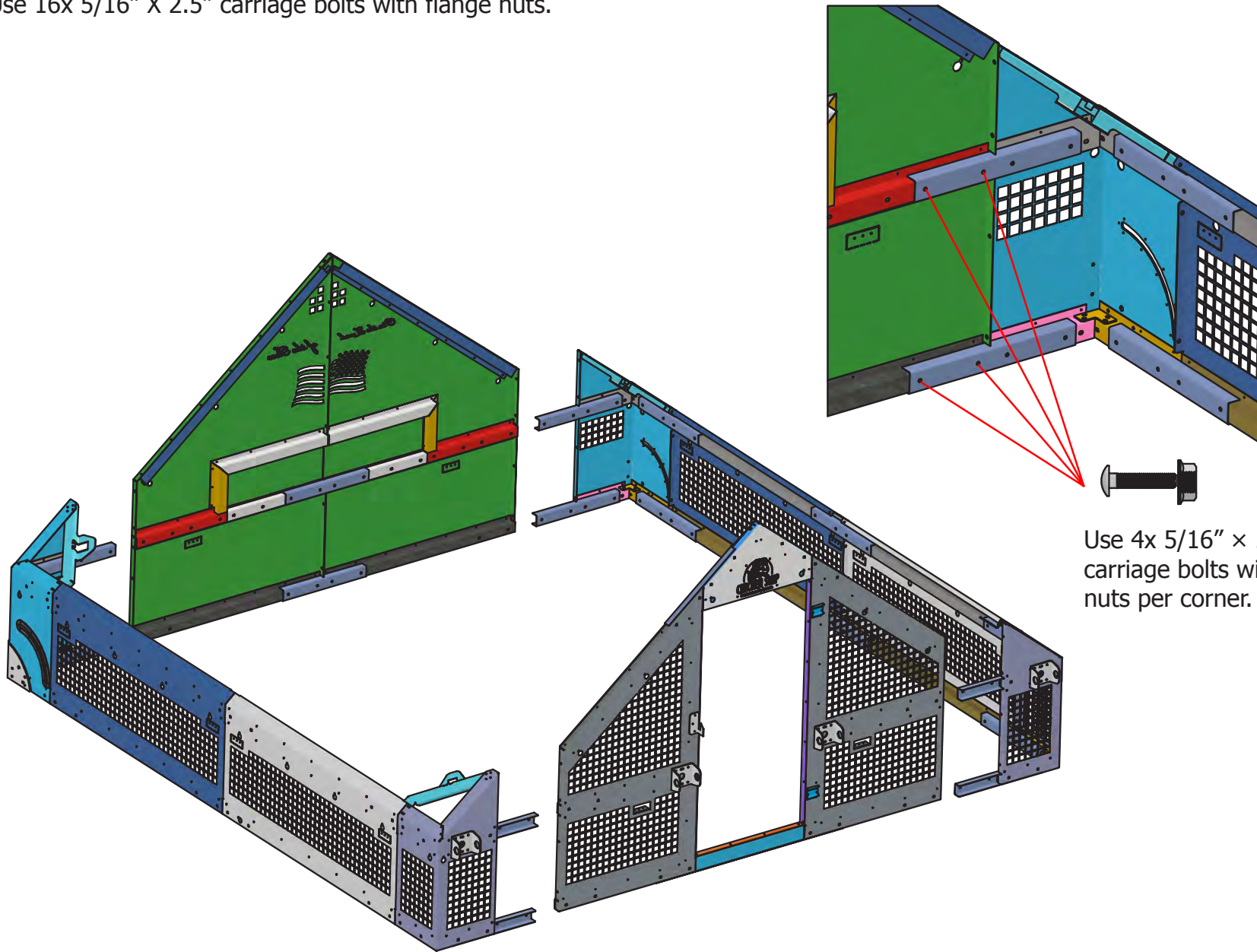

## Step 8: Panel Flange Assembly

Install 5/16" x 1" hex bolts with flange nuts along each panel flange and repeat on all four corners.

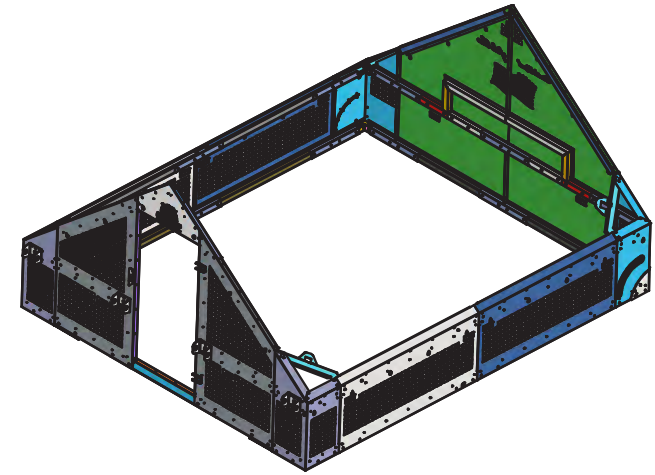
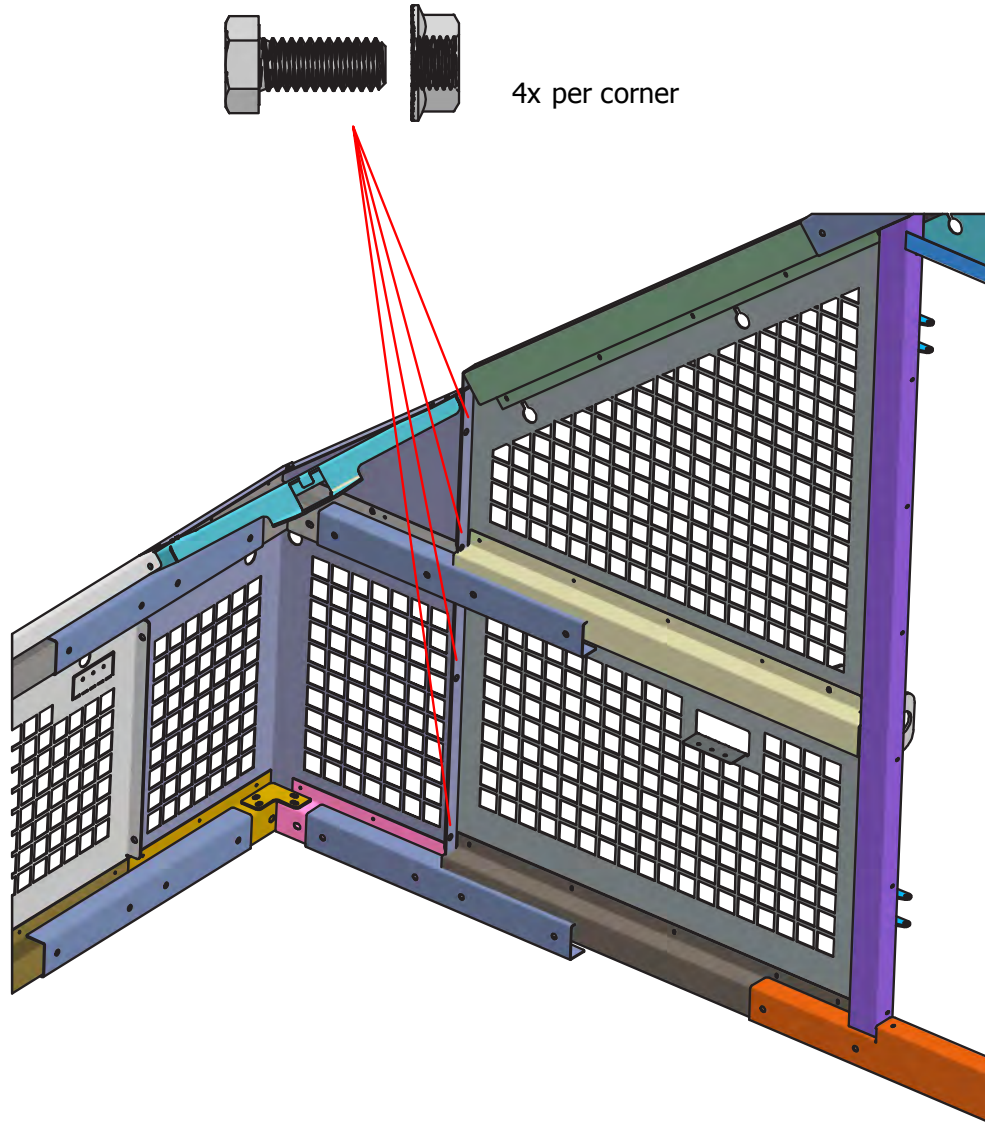

## Step 9: Sidewall Panel Assembly

Assembled view of sidewall panels.

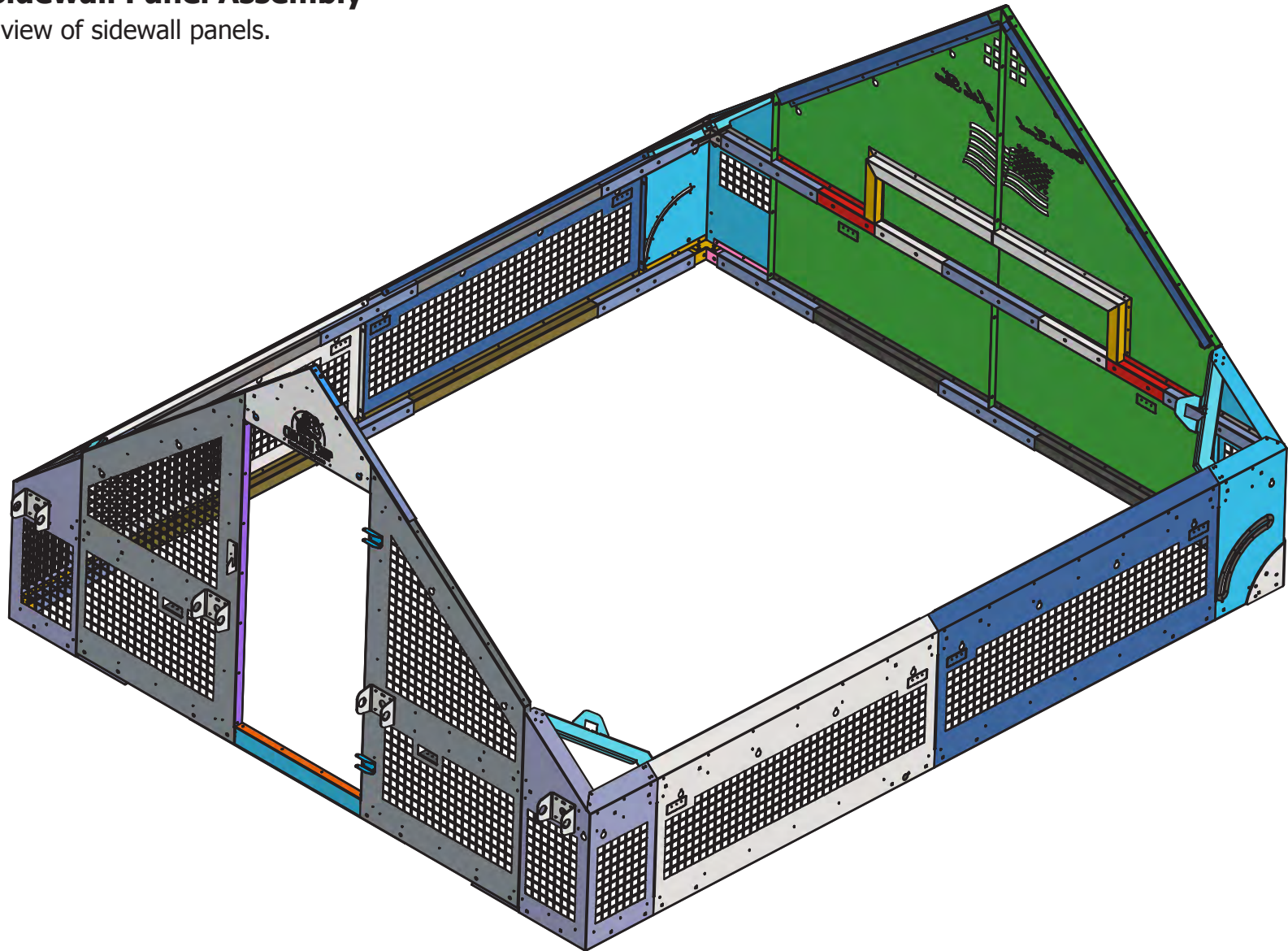



## Step 10: Middle Roof Support Installation

Install middle roof brace on the middle of both sidewall assemblies.

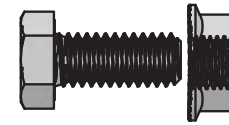
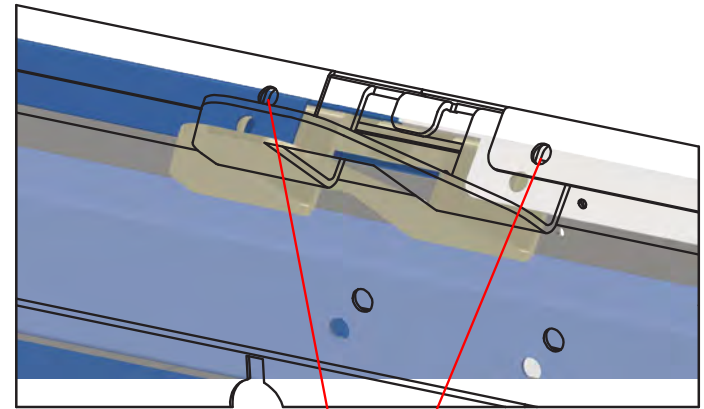
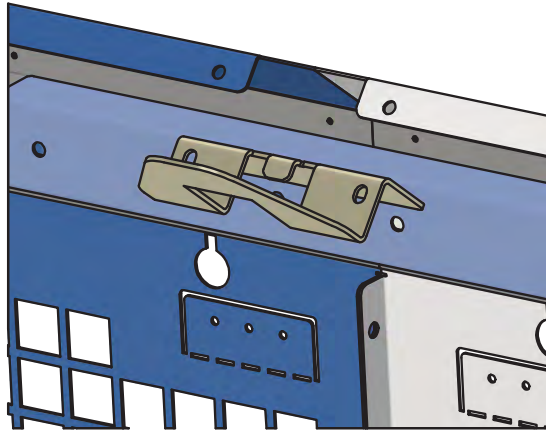

Use 4x 5/16" x 1" hex bolts with flange nuts.

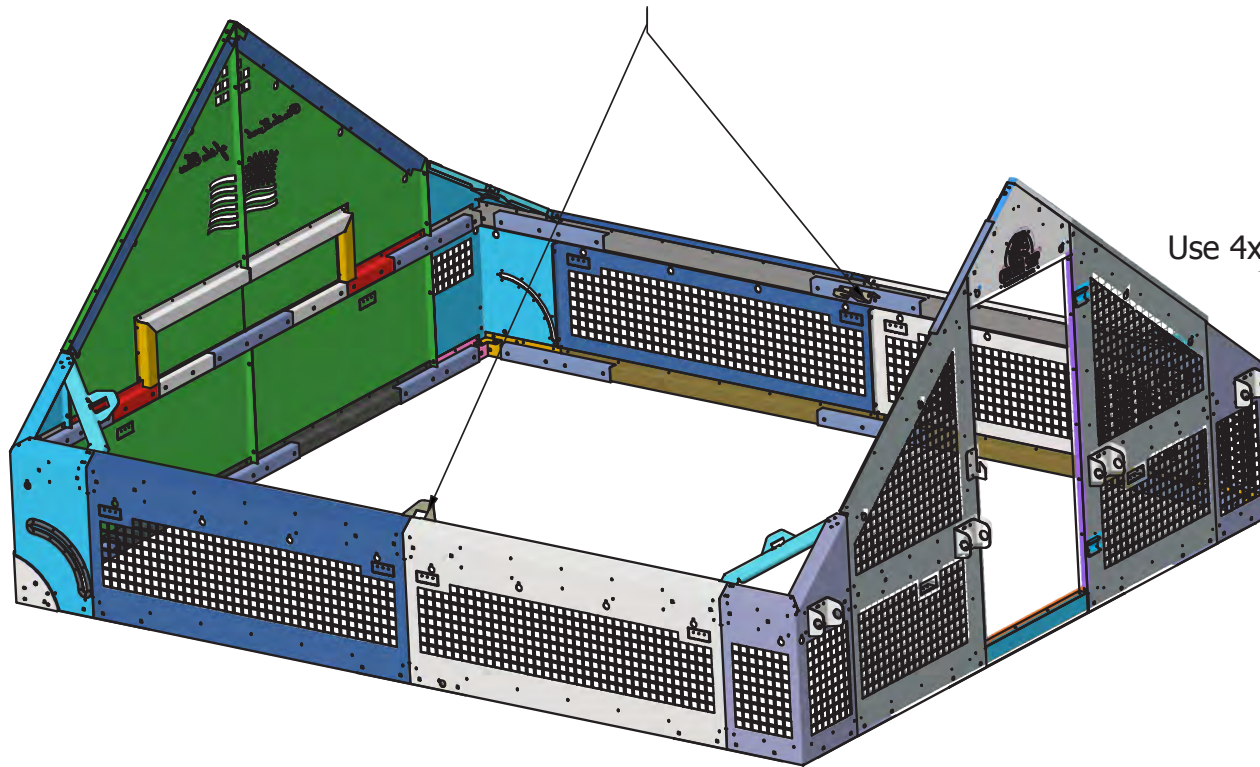

## Step 11: Ridge Assembly

Install using 8x 5/16" x 1" hex bolts with flange nuts.

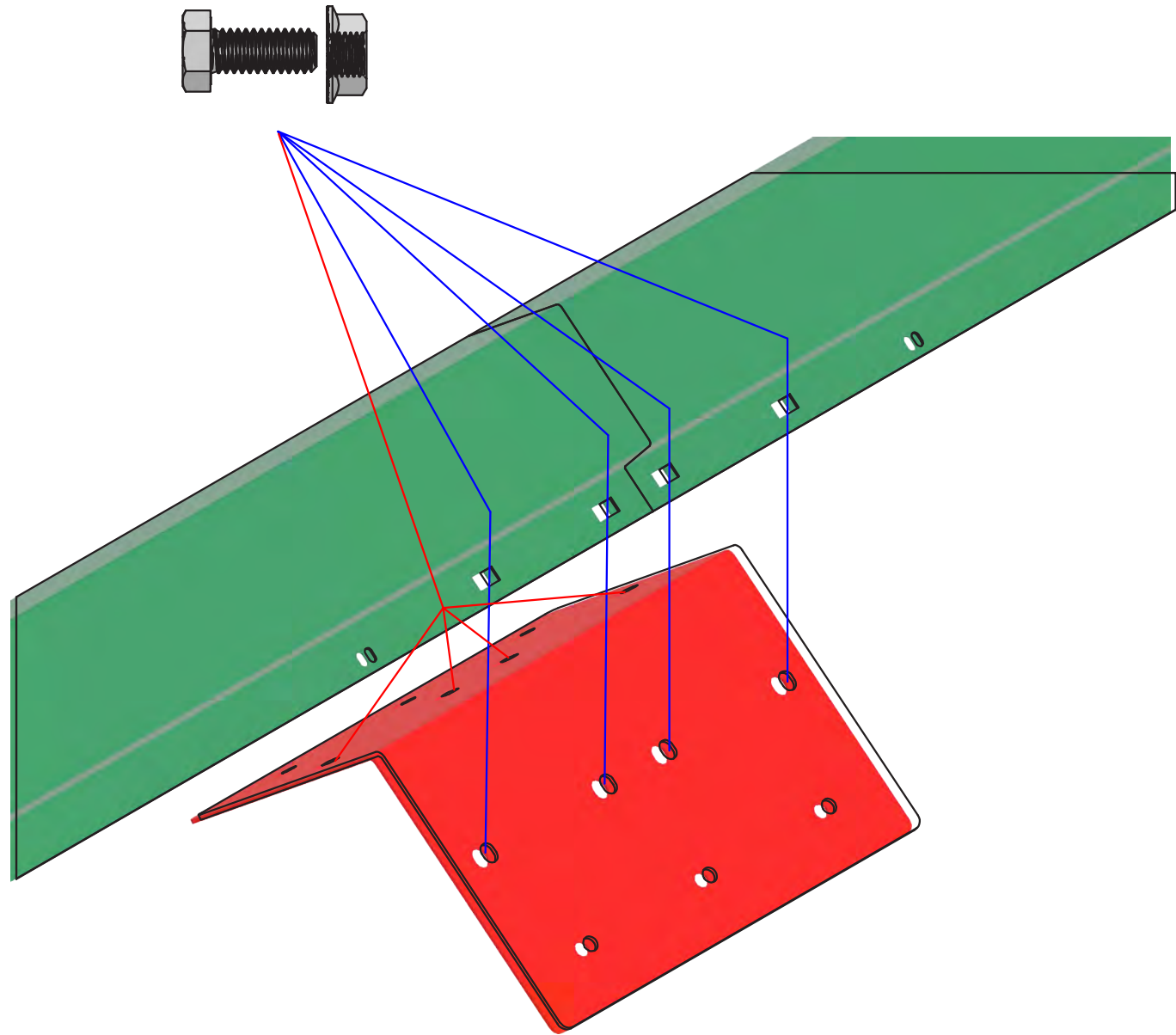

## Step 12: Ridge Cap Installation

Install ridge cap onto gable walls using  
4x 5/16" x 1" hex bolts with flange nuts.

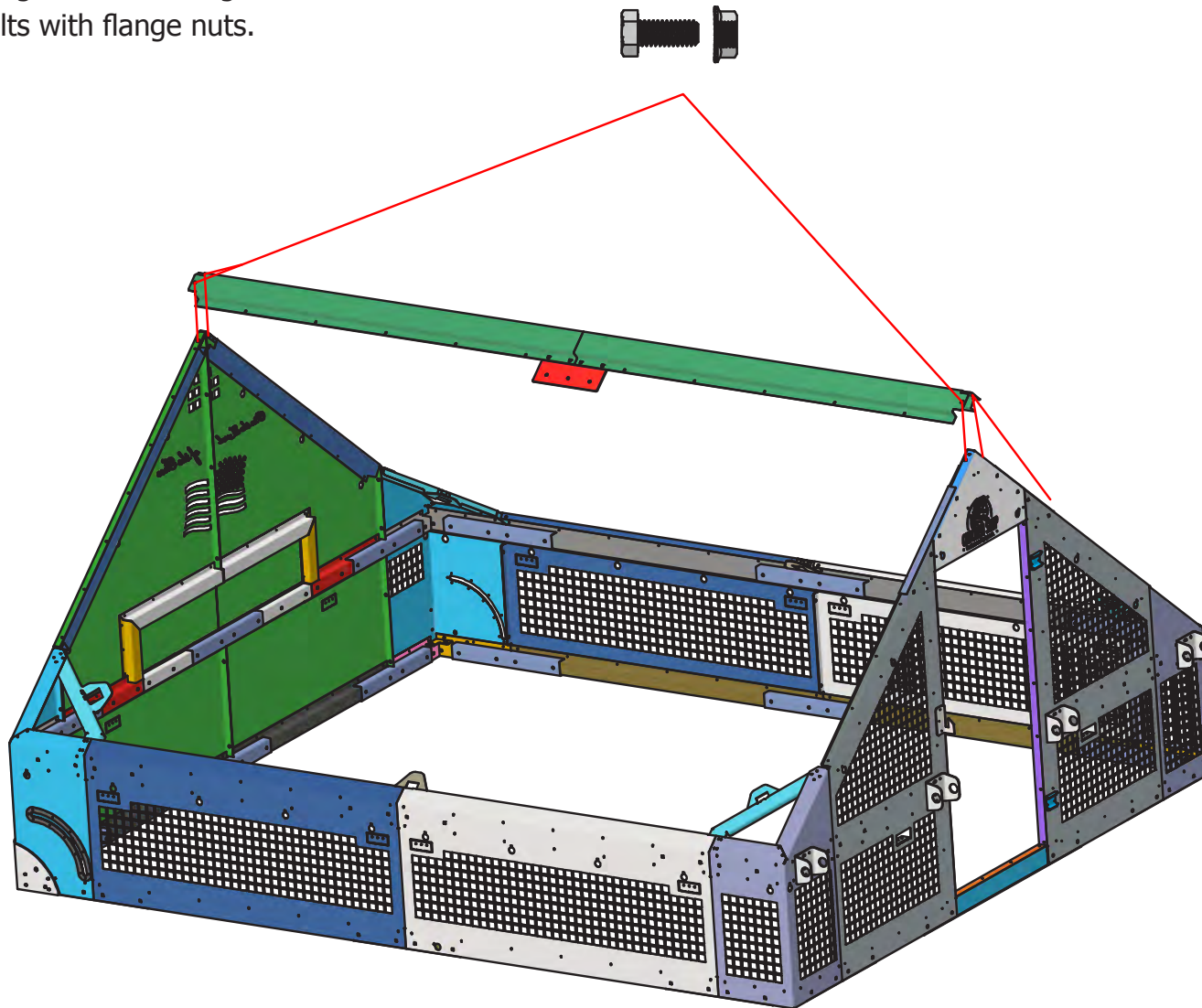

## Step 13: Roof Brace Installation

Corner roof braces are longer than center roof brace.



Use 6x 5/16" x 2.5" carriage bolts with flange nuts.

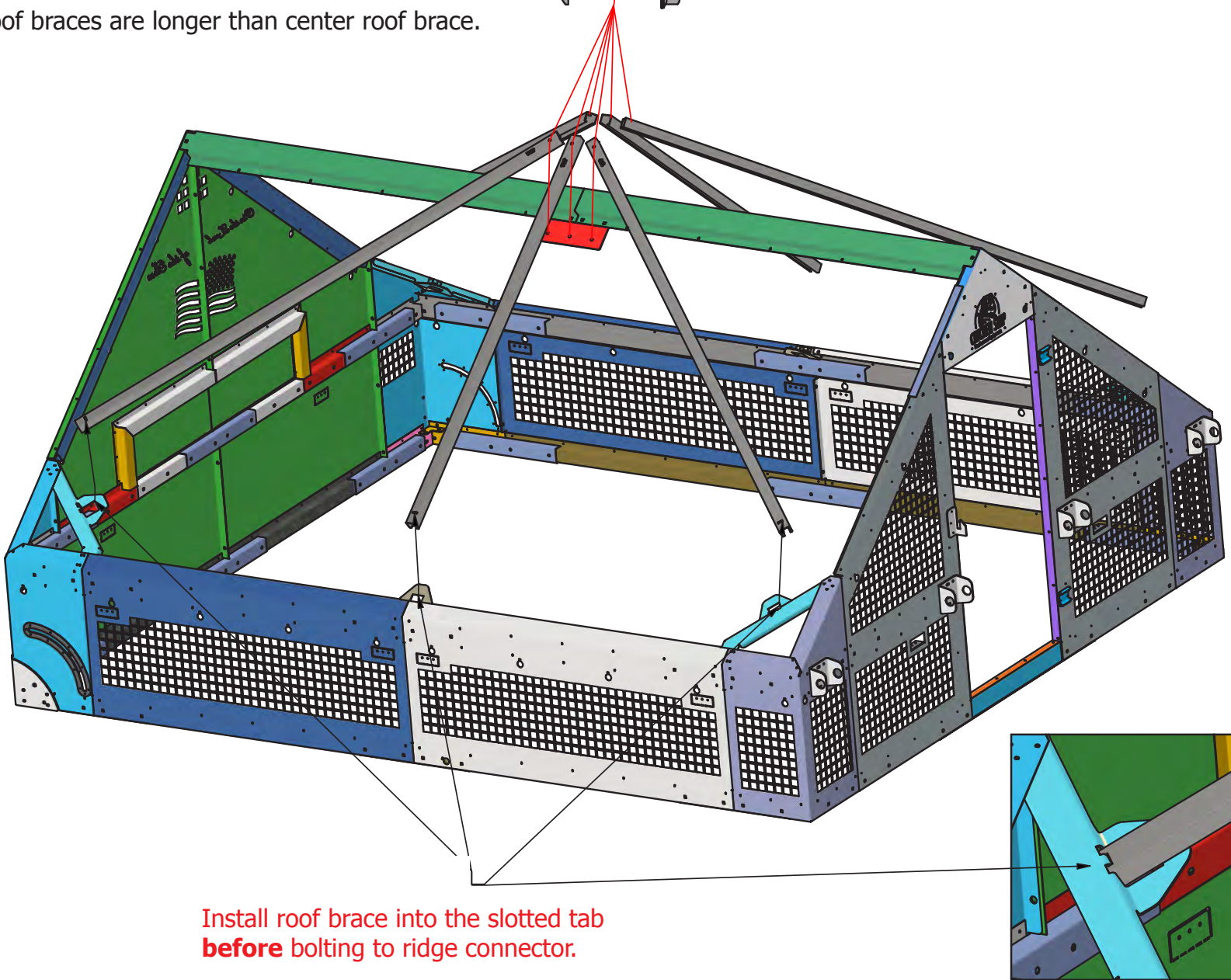

Install roof brace into the slotted tab  
**before** bolting to ridge connector.



## Step 14: Door and Latch Installation



Use 1x 1/4" x 2.5" hex bolt with lock nut to install the door latch. Tighten until slight resistance is felt when operating latch.

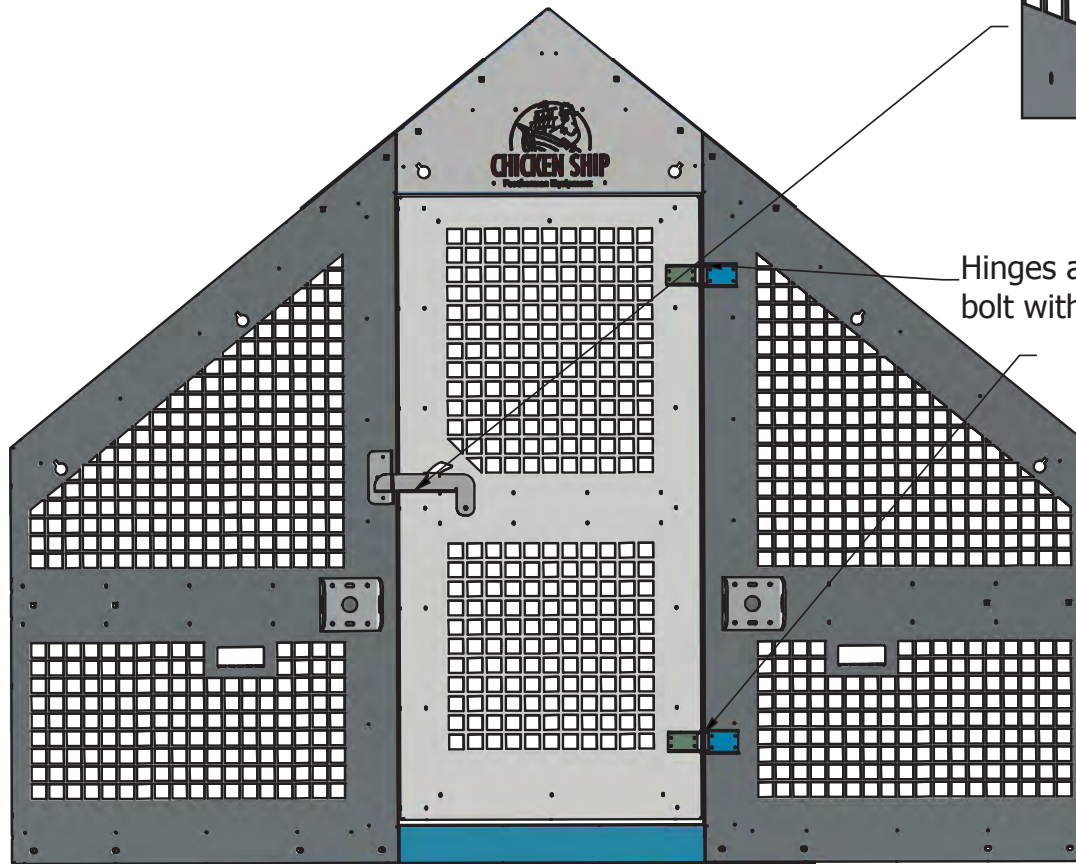
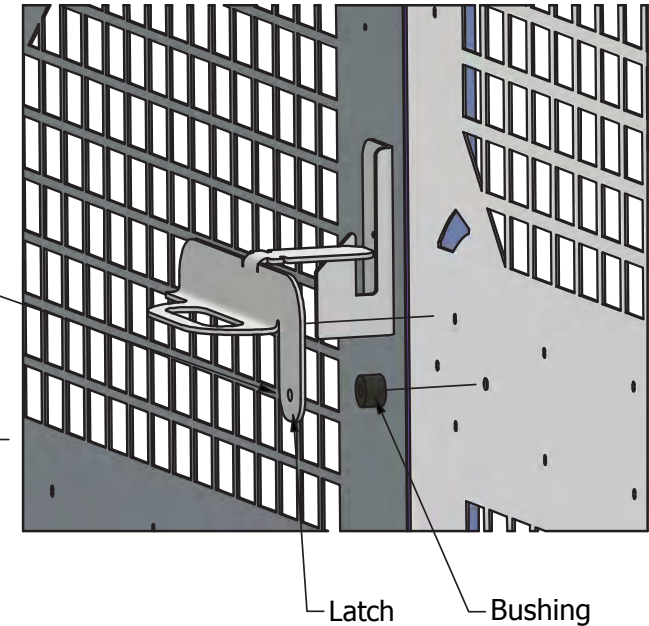



## Step 15: Wheel Assembly

There are right and left-hand parts.

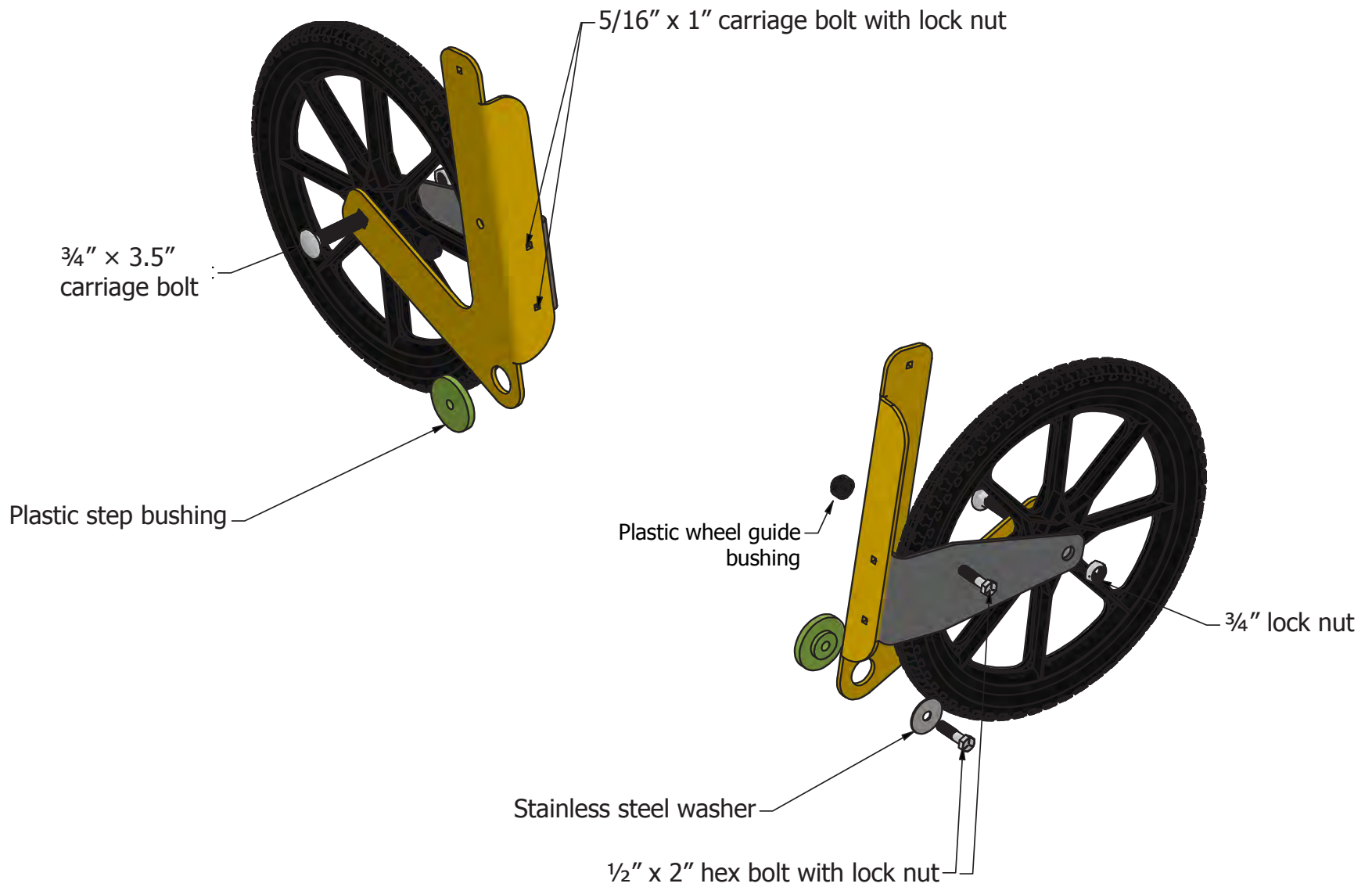

## Step 16: Wheel Installation

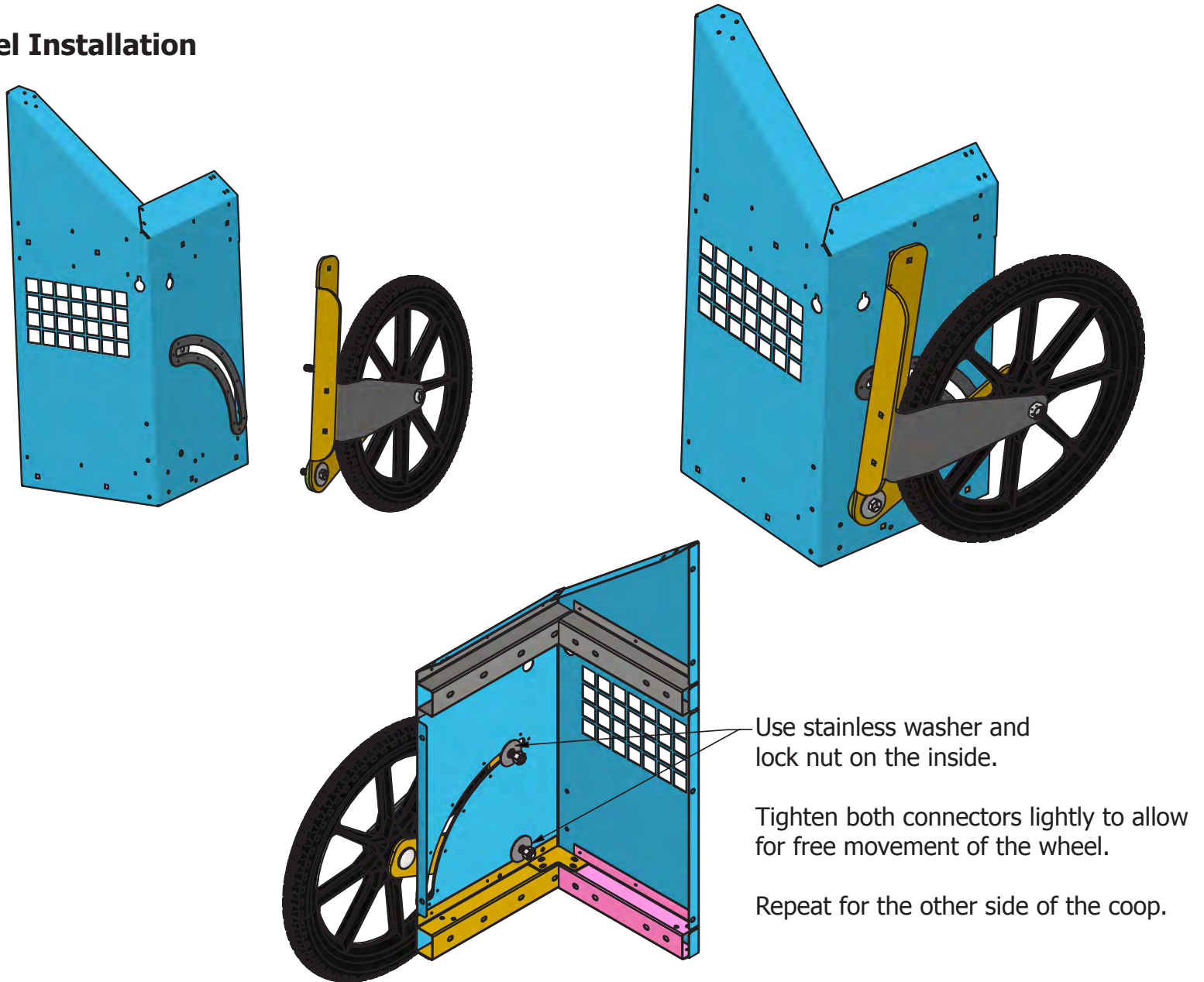

## Step 17: Handle Installation

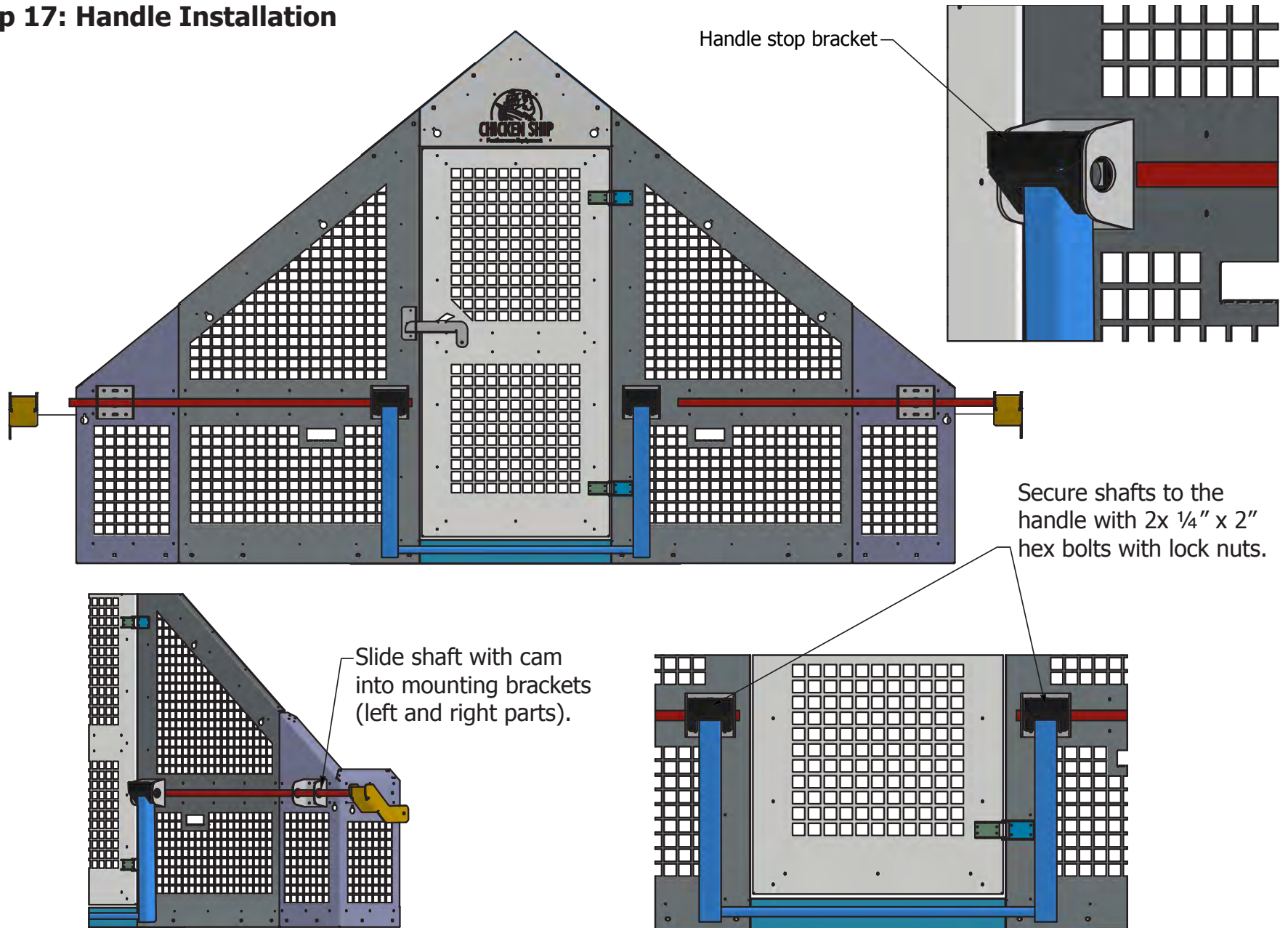

## Handle Assembled View

Use 1" x 2" hex bolt with lock nut.

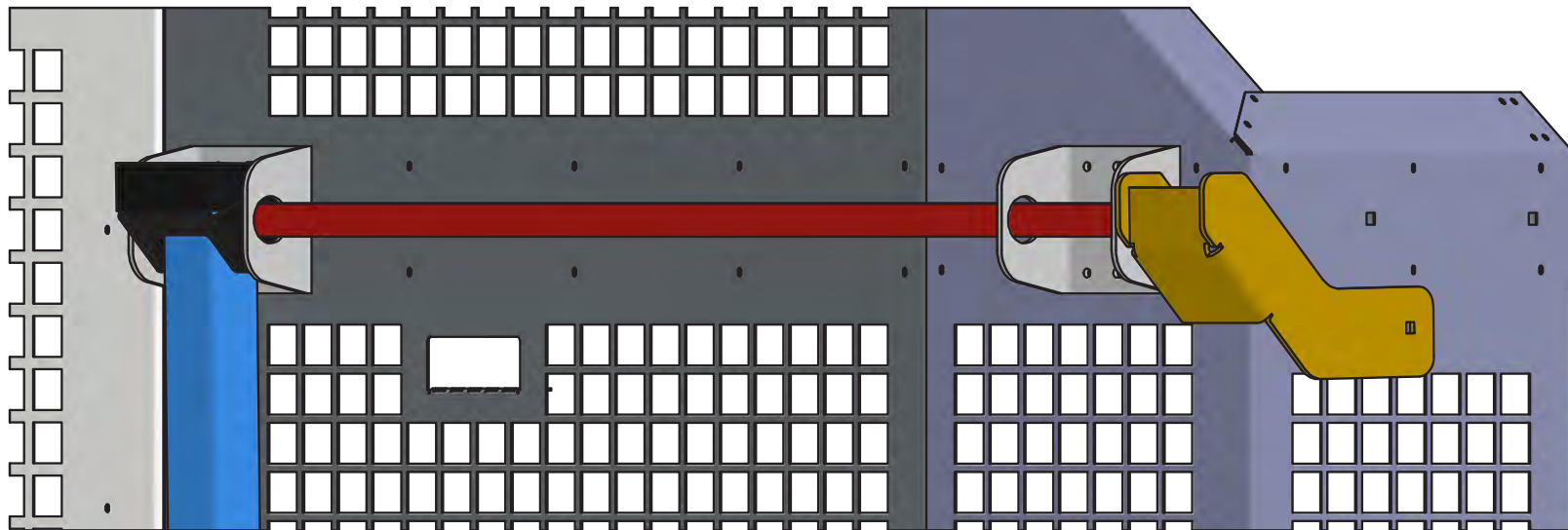
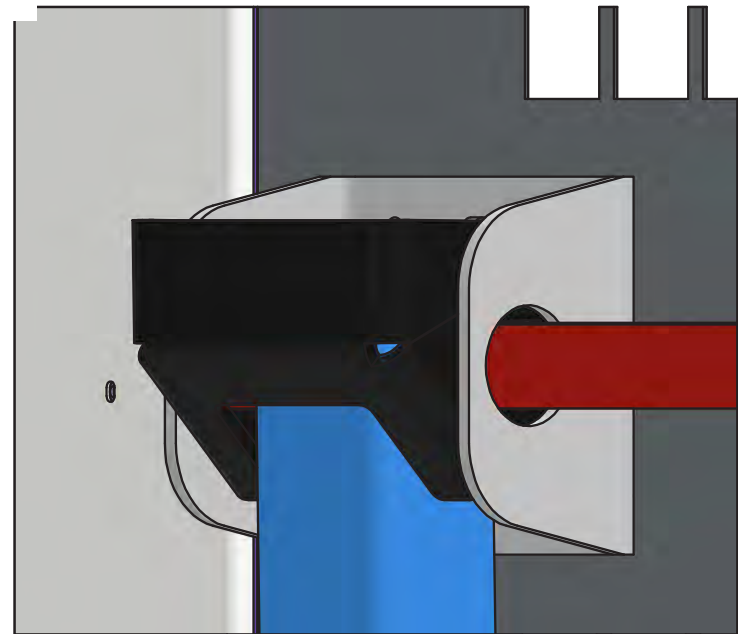
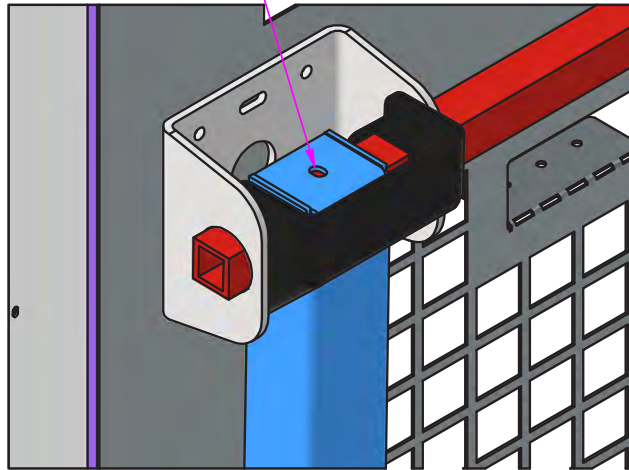

## Step 18: Wheel Pull Channels

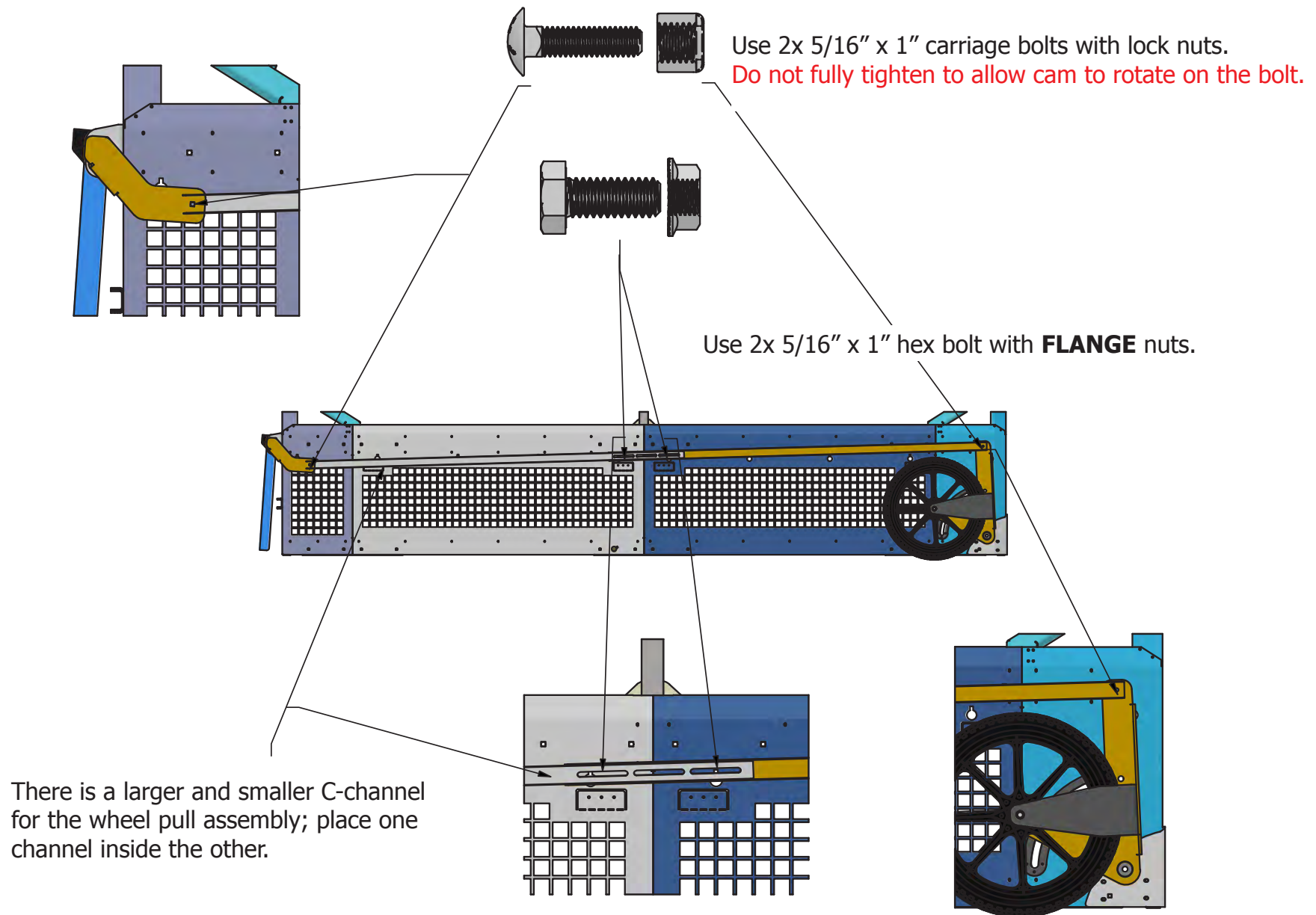



## Assembled View

Final view of fully assembled Chicken Ship (without tarp).

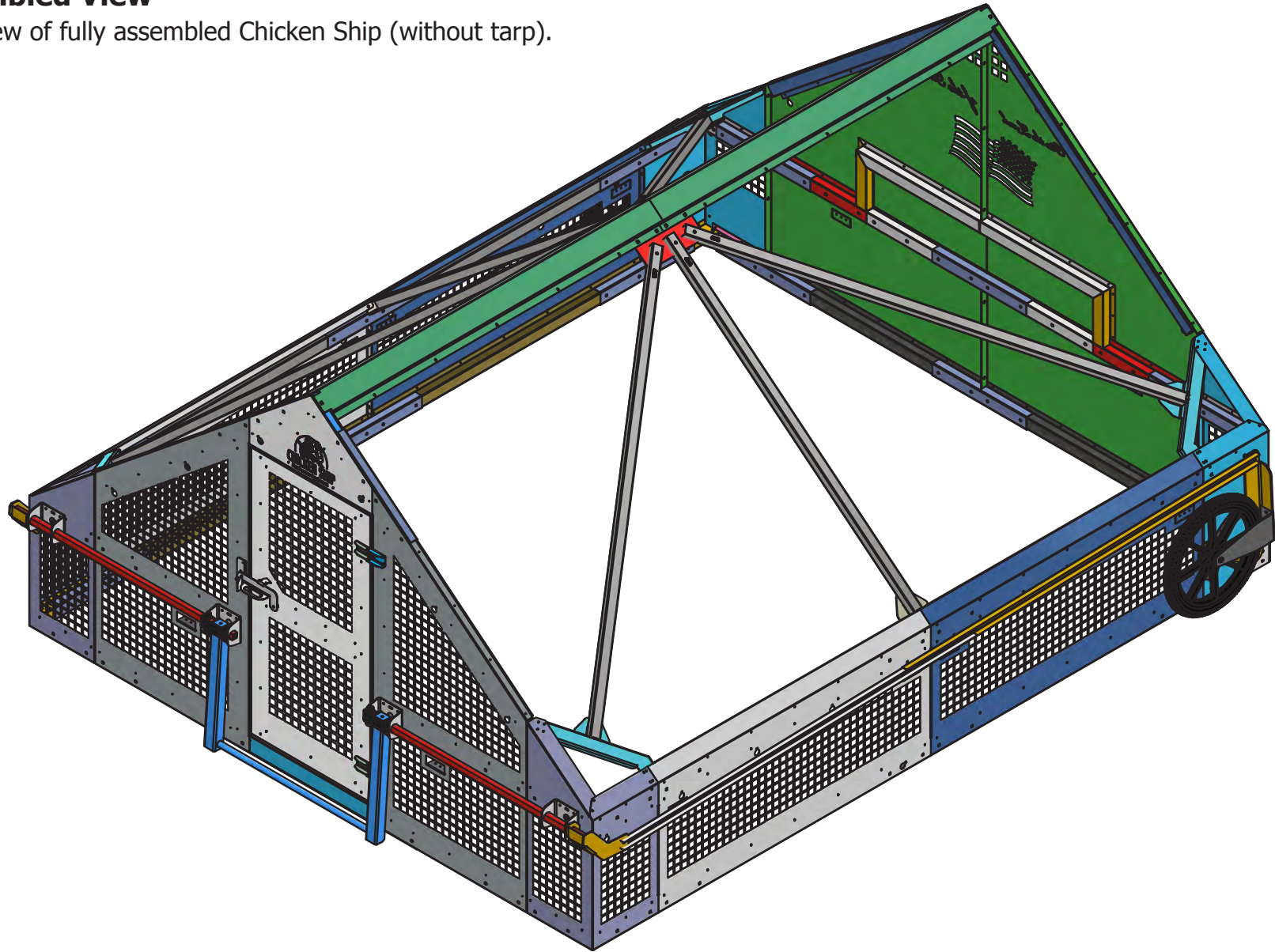

# WE'RE HERE IF YOU NEED US.

Your Chicken Ship comes with a lifetime warranty from the date of purchase. If you ever need a replacement part, have questions, or want to make sure you're getting the most out of your equipment, we're here to help.

**660.684.6035 | [customerservice@feathermanequipment.com](mailto:customerservice@feathermanequipment.com)**

For video tips and how-to guides, scan the QR code on this page or visit:  
**<https://www.feathermanequipment.com/how-to-videos/>**

**Scan for video tips  
and how-to guides**





## JOIN OUR COMMUNITY.

Our work is about more than gear—it's about the stories you create and the way you care for your birds and your farm. Share your Chicken Ship stories and tag us on social:

 [@feathermanequipment](https://www.instagram.com/feathermanequipment)

 [@feathermanequipment](https://www.youtube.com/feathermanequipment)

 [Featherman Equipment](https://www.facebook.com/FeathermanEquipment)

 [Featherman Equipment](https://www.linkedin.com/company/FeathermanEquipment)

Thank you for trusting us to be a small part of your farm's bigger picture.  
Here's to safe, thoughtful stewardship of your flocks for years to come.

*—The Featherman Team*